

**Agency: Commerce, Community and Economic Development****Grants to Named Recipients (AS 37.05.316)****Grant Recipient: Partners for Progress in Delta, Inc.****Federal Tax ID: 26-2495109****Project Title:****Project Type:** Remodel, Reconstruction and Upgrades

# Partners for Progress in Delta, Inc. - Career Advancement Center Expansion

**State Funding Requested: \$45,000****House District: 12 / F**

Future Funding May Be Requested

**Brief Project Description:**

Design and build expansion of Career Advancement Center and upgrade existing facility.

**Funding Plan:**

Total Project Cost: \$45,000

Funding Already Secured: (\$0)

FY2013 State Funding Request: (\$45,000)

Project Deficit: \$0

*Funding Details:*

None.

**Detailed Project Description and Justification:**

To better meet individual and industry market needs in the state for more skilled workers by constructing additional customized space such as lab space to offer science classes, improved videoconferencing equipment and space to hold large group meetings (more than 25 and up to 100), a Department of Environmental Conservation approved kitchen, other items, and modify existing facility. Partners for Progress desires to begin design work leading to the construction of an expansion of the existing facility.

**Project Timeline:**

FY 2013 Preliminary Design

FY 2014 Detail Design

FY 2015 Site and building work and completion

**Entity Responsible for the Ongoing Operation and Maintenance of this Project:**

Partners for Progress in Delta, Inc.

**Grant Recipient Contact Information:**

Name:	Karen Cedzo
Title:	Member
Address:	PO Box 956 Delta Junction, Alaska 99737
Phone Number:	(907)895-4605
Email:	karen.cedzo@gmail.com

Has this project been through a public review process at the local level and is it a community priority? ☒ Yes ☐ No



# Partners for Progress in Delta, Inc.

---

## **Delta Career Advancement Center Expansion**

### **Delta Junction, Alaska**

#### **BACKGROUND AND NEED**

The **Delta Career Advancement Center** as is operated jointly by the **Partners for Progress in Delta, Inc.** and the Delta/Greely School District. In 2008 the Alaska Legislature named the Delta Center a state **Regional Training Center**. The existing facility which opened in 2005 has a 7,000 square-foot workshop area, one 24-station computer lab and one classroom. Classes and training delivered by the partners keep the facility busy year-round. To meet individual and industry market needs for more skilled workers, we require additional customized space such as lab space to offer science classes, improved videoconferencing equipment and space to hold large group meetings (more than 25 and up to 100). There is also interest in and a regional need for a Department of Environmental Conservation (DEC) approved kitchen to assist desired and increased entrepreneurial activity within the agricultural community, as well as build upon a strong culinary arts program in the high school to include adult culinary arts career pathways. Since January 1, 2012 and through February 19, 2012 the Center served 124 area residents—50 are enrolled in University classes including Russian, Math, Photoshop, AutoCAD, Word and distance delivered information technology courses. Another 44 have participated in workshops delivered by partners including pesticide application, cold climate building and drinking water for emergencies. And in this short period, 30 have already been through the doors for testing—either placement or course completion. Late start classes this spring include certified nurse aide, a nine-credit university course leading to certification upon completion of the state examination, weatherization academies and the three-week Heavy Equipment Operator Academy held in June. To date in FY 12, the Center has served 239 area residents

#### **STEPS TOWARD MEETING THE NEED**

1. The board of directors of Partners for Progress in Delta, Inc. met with members of the greater Delta legislative delegation in December 2011 to explain the need for more and different use space.
2. In 2003 the original preliminary facility design costs were estimated at \$36,000 in a design/build proposal. That figure is very low compared with traditional design services. In recent years construction projects of several of our partners indicate that the cost of

project architectural drawings ranges from 10-to-12 percent of total construction cost. In Fairbanks the cost of facility expansion construction was \$300 per square foot for the Carlson Center (10,000 square feet). A DEC kitchen could up that cost to \$350 per square foot. We are currently estimating \$300 sq. /ft. x 6,000 square feet to come up with an **estimated project construction cost of \$1.8 million**. Total design services cost to complete the design would be 10% of that construction cost, or approximately \$180,000. At this time we are looking for “Schematic design services only” (25-35% of the total design fee) and will request that the architects include a cost estimate for the project.

3. After discussion among the partners we estimate a 6,000 square-foot expansion to provide the additional space needed for classes, offices, labs and special meeting and training spaces.
4. Currently, the Delta/Greely School District owns the facility which is on state land that has been transferred to the district. An expanded facility could be a stand-alone adjoining facility that could be owned outright by the Patterns for Progress in Delta Inc. This will be the preferred ownership, especially if the additional square footage will count against the school district’s capital improvement plan.
5. The Department of Environmental Conservation approved kitchen would permit the Cooperative Extension Service to work with area residents who are interested in developing business opportunities for agricultural products that can be processed, marketed and sold statewide.
6. Finally, the expansion will be mindful of the state’s current and aggressive policy for Energy goals that affect the Energy Sector economy dramatically within the next seven to 12 years. In addition “green job” training leading to an Energy Sector Workforce Plan for Alaska. It will be imperative for Delta, in its plan for expansion of its Regional Training Center, to be mindful of this evolving workforce development effort, especially since Delta already is involved in wind energy, biomass boilers and other alternative energy for fuel activities. The expansion should be not only a model for future construction of facilities, but also a training opportunity for those taking education and training programs at the Center. We believe this expansion can showcase new technologies as well as provide on-the-job training and education opportunities for area residents and young adults seeking skilled jobs in the workforce.

### **BOTTOM LINE: \$45,000.00 Can Jumpstart this Expansion**

\$45,000 appears to be a reasonable amount to acquire schematic design services that then permit us to work toward more fully developed design drawings and a more accurate estimate of construction costs for an expansion of the Delta Career Advancement Center, located at 1696 North Clearwater Avenue in Delta Junction, AK.

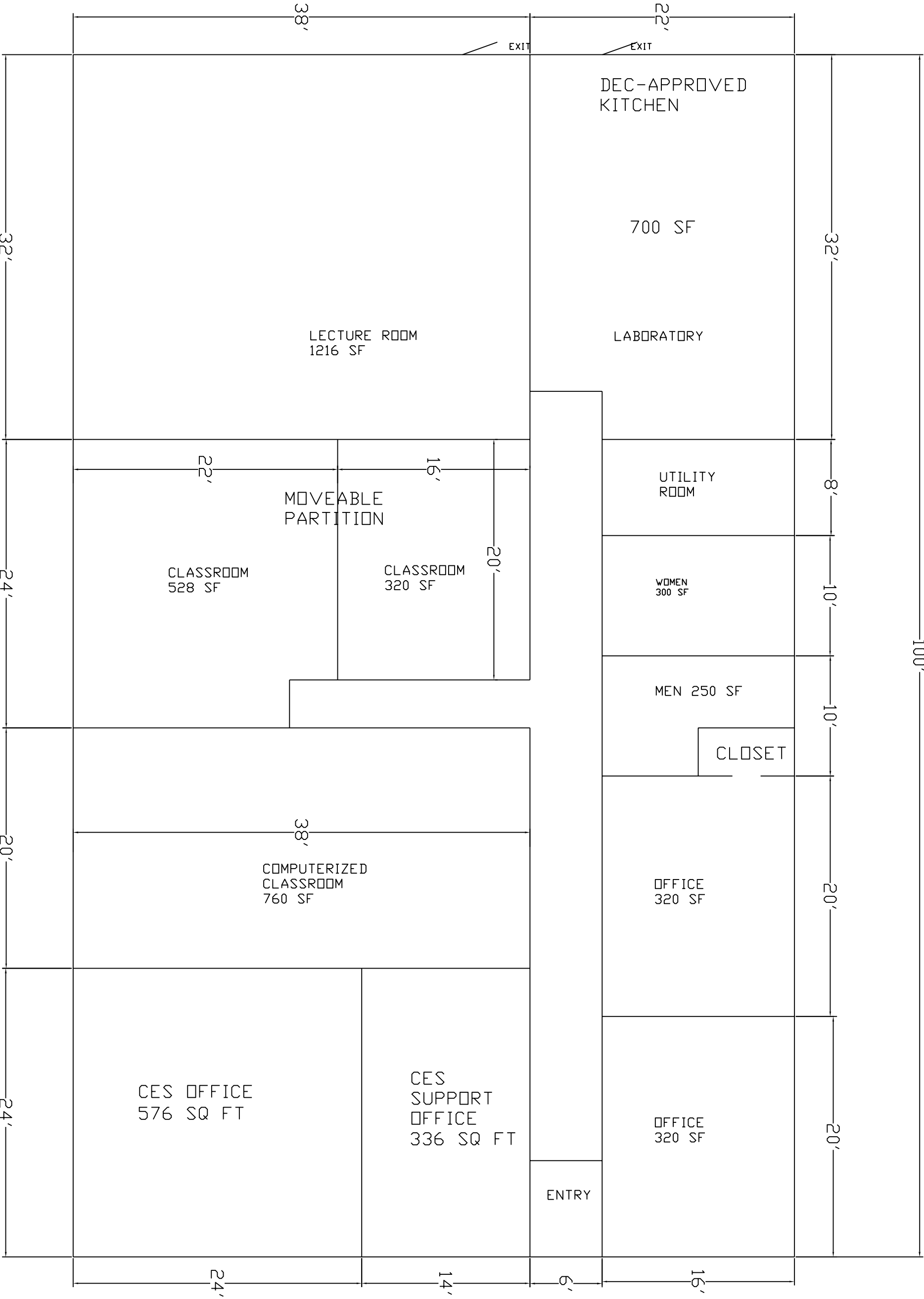

PROPOSED 6000 SF FACILITY (DRAFT)  
JD 1-13-2012 PPD